

36 ^s	3.04 ^s	11 ^s	3.04	17 ^s 6 17 ^s	3.04	11 ^s	3.04 ^s	36 ^s		
36 ^s	3.16	36 ^s	2.67 ^s	17 ^s 6 17 ^s	2.67 ^s	36 ^s	3.16	36 ^s		
1.58	1.01	93 ^s	84 ^s	1.01	1.36	1.36	1.01	84 ^s 93 ^s	1.01	1.58
	2.18 ^s		2.18 ^s	6	3.21 ^s	6	2.18 ^s		2.18 ^s	3.52 ^s
	3.52 ^s		3.21 ^s				3.21 ^s		2.18 ^s	3.52 ^s

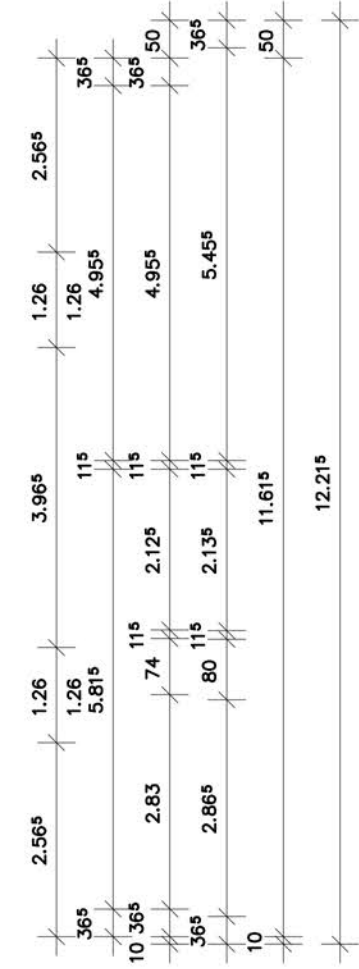
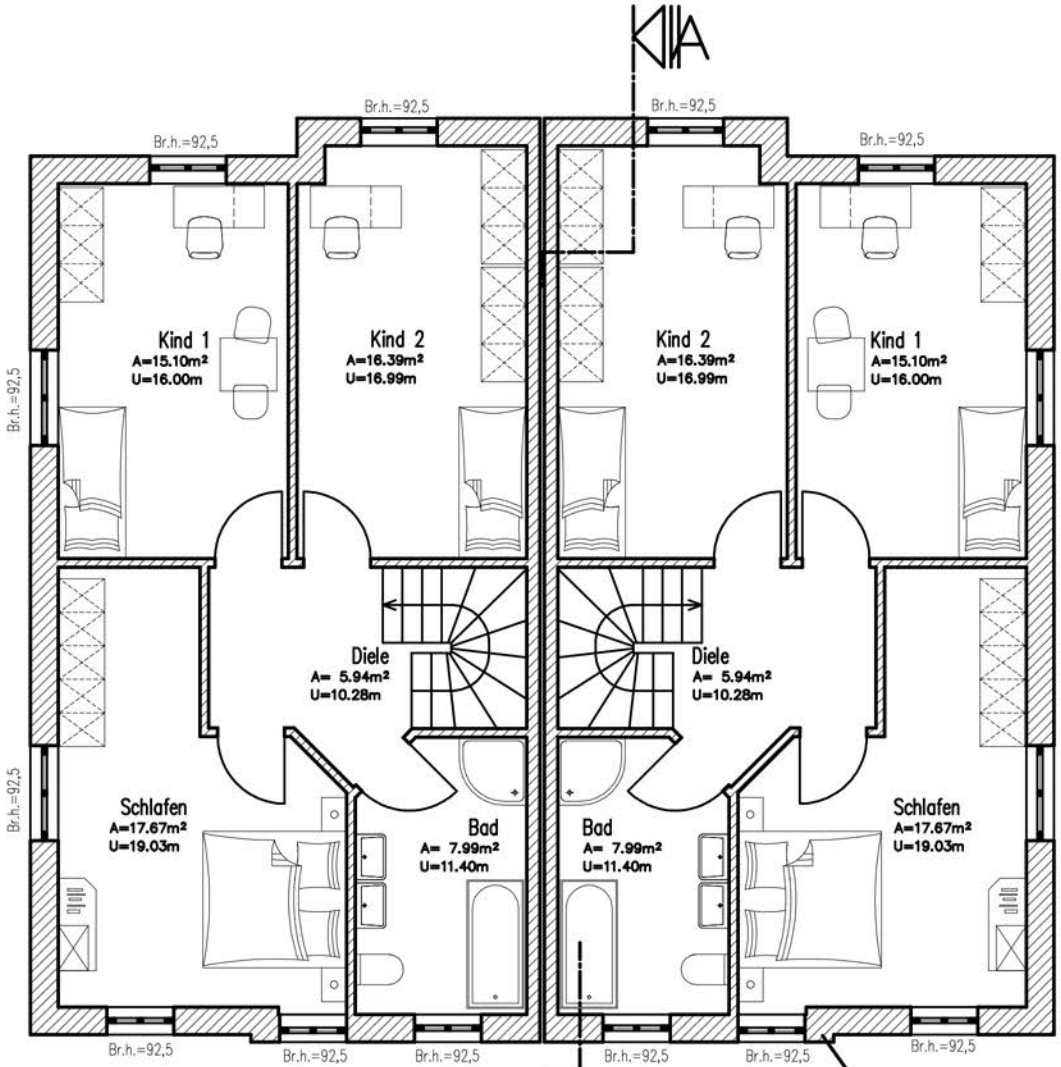
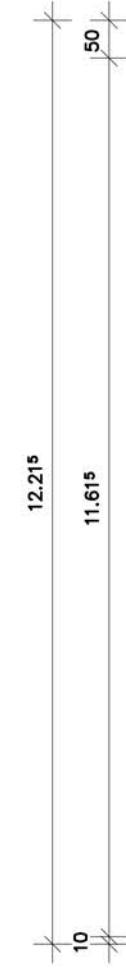
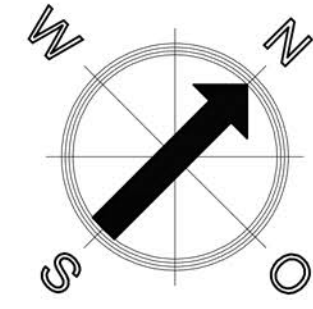

Zweifamilienhaus

2.91 ^s	3.82 ^s	3.82 ^s	2.91 ^s											
1.01	88 ^s	1.02	38	88 ^s	90	88 ^s	77 ^s 6 77 ^s	88 ^s	90	88 ^s	38	1.02	88 ^s	1.01
36 ^s	1.26	2.55	36 ^s	1.26	11 ^s	1.26	17 ^s 6 17 ^s	1.26	11 ^s	1.26	36 ^s	1.26	36 ^s	
36 ^s		3.81 ^s		11 ^s	2.27	17 ^s 6 17 ^s	2.27	11 ^s	2.27	11 ^s	3.81 ^s		36 ^s	
36 ^s		1.87 ^s	1.20	74	80	1.47	17 ^s 6 17 ^s	1.47	80	74	1.20	1.87 ^s	36 ^s	
36 ^s	1.87 ^s	11 ^s	1.13	1.56	1.52	17 ^s 6 17 ^s	1.52	1.56	1.13	11 ^s	1.87 ^s	36 ^s		
					13.54									

M 1:100

