

36 ⁵		6.20		17 ⁵ 6 17 ⁵		6.20		36 ⁵	
36 ⁵	3.16	36 ⁵	2.67 ⁵	17 ⁵ 6 17 ⁵	2.67 ⁵	36 ⁵	3.16	36 ⁵	
1.20	1.76	56 ⁵ 46 ⁵	1.76	99	99	1.76	46 ⁵ 56 ⁵	1.76	1.20
	2.18 ⁵		2.18 ⁵			2.18 ⁵		2.18 ⁵	

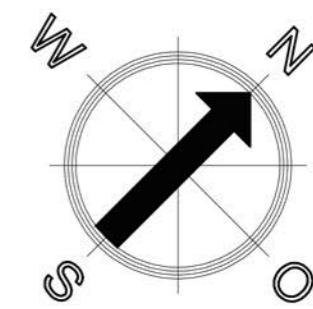

12.11⁵
11.61⁵
50

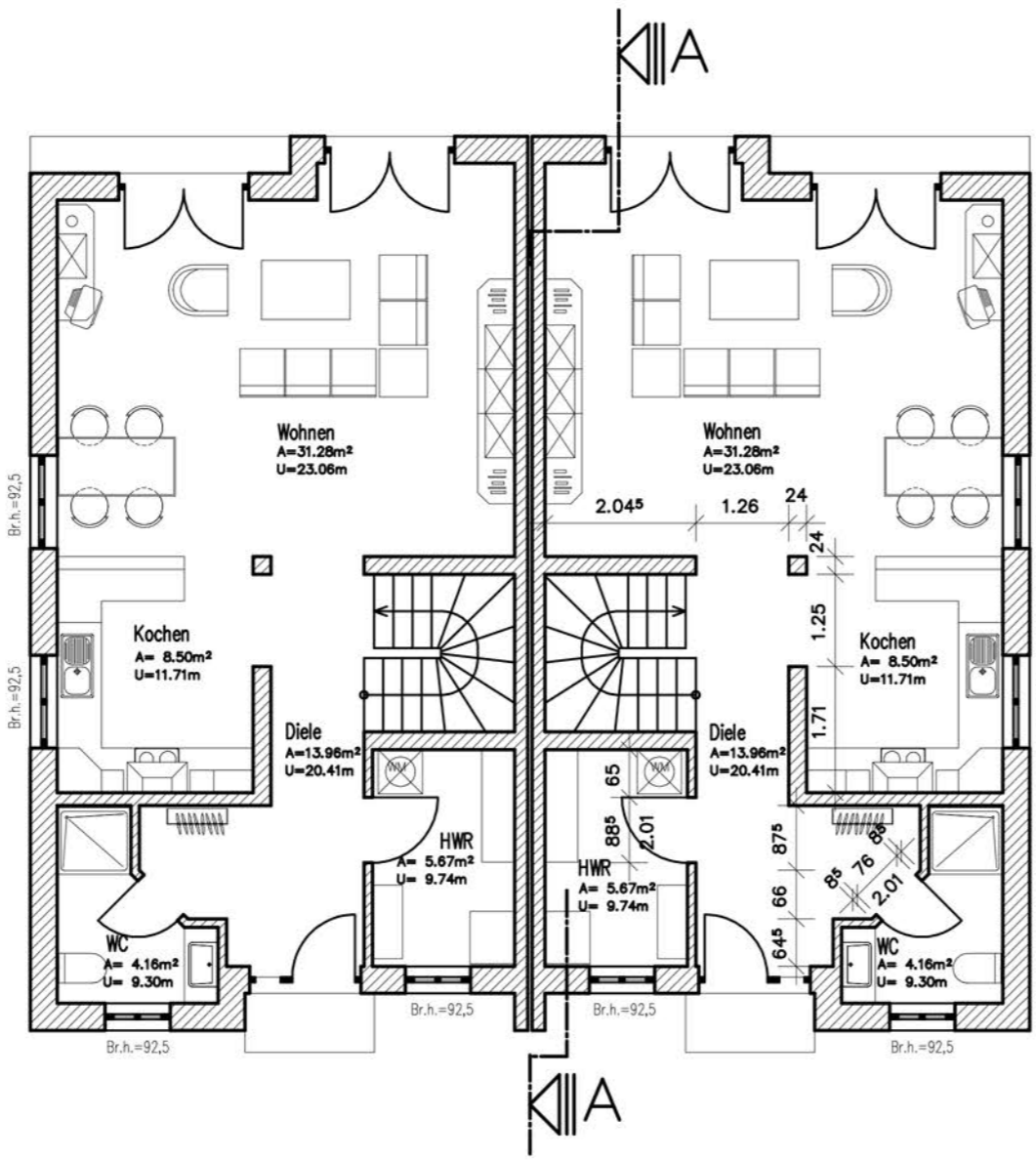

50
3.82⁵
1.26
1.26
1.44⁵
1.26
1.26
3.82⁵
17⁵
2.68
36⁵
36⁵
1.03
11⁵
61
92⁵
17⁵
50
36⁵
2.94
24
2.13⁵
24
4.83
11.61⁵
12.11⁵
50

Zweifamilienhaus

1.01	88 ⁵	1.01 ⁵	6	50	1.01	60	88 ⁵	77 ⁵	6	77 ⁵	88 ⁵	60	1.01	50	6	1.01 ⁵	88 ⁵	1.01
36 ⁵	1.26	36 ⁵			3.65 ⁵	1.26	17 ⁵ 6 17 ⁵	1.26		3.65 ⁵	2.18 ⁵	36 ⁵	1.26	36 ⁵		1.26	36 ⁵	36 ⁵
36 ⁵	2.18	11 ⁵			1.86	11 ⁵	1.93	17 ⁵ 6 17 ⁵		1.93	1.86	11 ⁵	2.18	36 ⁵		2.18	36 ⁵	36 ⁵
36 ⁵	1.00	11 ⁵	61	45 ⁵	1.86	11 ⁵	1.93	17 ⁵ 6 17 ⁵		1.93	1.86	11 ⁵	45 ⁵	61	1.00	1.00	36 ⁵	36 ⁵
															13.54			

